

29 170 001 LINEARE SINGLE-LEVER BATH/SHOWER MIXER

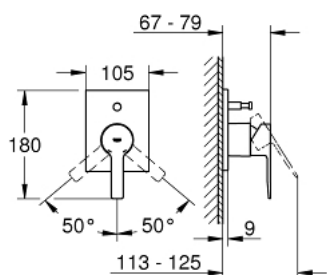

PRODUCT DESCRIPTION

- Colour: chrome
- final installation set for
- 32 963 001
- without concealed body
- metal lever
- GROHE Long-Life finish
- automatic diverter: bath/shower
- escutcheon- and shaft-sealing
- metal escutcheon
- covered fixing
- min. recommended pressure 100 kPa



29 170 001 **LINEARE SINGLE-LEVER BATH/SHOWER MIXER**

SPARE PARTS, December 2017 – spareParts.validDate.now

1: Diverter (Order-nr. 46737000)

2: Lever (Order-nr. 46988000)

